



📍 FACTORY LOCATION

U-10, Navrang Tower, Satadhar Corss Road,
Sola Road, Ahmedabad - 380 061

M: +91 9426084362, 9662058739, 9662058721

Email: royalwcf@gmail.com

Website: www.royalwcf.com

- Fountain Nozzles
- Fountain Accessories
- Underwater LED Luminaires





Company Profile

2
Page

JAS-ANZ

WORKING DIRECTORS:

Indravadan J Patel :

Worked approximately for 35 years with World renowned company **Philips India Limited** as Audio Video Dealer' and wide experience in

ELECTRONICS
AND COMPUTERIZED TECHNOLOGY.

Since last 27 years with water Fountain Technology

Yashraj M. Patel :

Well experienced since last 10 years with Electronic, Automation Engineering and water fountain Technology

Biran M. Amin :

Well experience since last 15 years with fountain Technology.

Shikha J. Patel :

Well experience in technical support, Diploma in Plastic Engineering



Company Profile

P
3
Page

Royal world class fountain deals in:

- * Musical Dancing Fountain
- * Light & Sound Show
- * Out door Park Fountain
- * Floating Water Fountain
- * Fountain Accessories
- * Laser with Fire Show
- * Amusement Park Division
- * Electronic automation project

Royal World Class Fountain believes in

- * Providing value to our customer with earning a reasonable return on our delivered value
- * Adaptability to change, while maintain our basic values and originals purpose.
- * Adhere to high standards of ethics and integrity
- * Make continuos improvement an integral part of the way we operate.
- * Attract, develop, motivate and retain highly competent, committed and creative people
- * Respond to our rapidly changing world with entrepreneurial approaches, innovative design, advanced technology and high quality, timely Delivery.



*Company
Profile*

P
4
Page

Royal World Class Fountain Experience

Escape from the stress of the moment as streams of water cascade downward across natural, polished river rocks. Clear your mind as nature's original lullaby slowly melts away your tension.

The soothing sound of naturally flowing water has always provided the perfect backdrop for relaxation and concentration. Perfect fountains bring you these vital benefits, while their creative design adds beauty and tranquillity to any environment. Transport yourself to an oasis of serenity where your own nature, renewed and refreshed.

Your experience our mission

To create an experience for our customers and us that established Royal World Class Fountain as the perfect brand. It is our intension that your experience of our Royal World Class Fountain company will exceed your expectations. If ever it happens that we do not live up to our promise please notify us so we may



*Company
Profile*

P
5
age

JAS-ANZ

ROYAL WORLD CLASS FOUNTAIN COMPANY PROFILE & VISION

Improving the standard of living and quality of our life within the circle of our influence.

In Fountain Manufacturing industry, Royal world class fountain is a leading manufacturer and exporter

Musical Fountain with creative and designer touch alone with huge experience of three decades.

With this huge experience Royal world class fountain has market Nation wide as well as in international

market The company was established by Shri Indravadan J Patel in 1964 and now it is solely handled by Mr. Sanjay I. Patel and Yashraj M Patel..



Certificate of Registration



This is to certify that Management System of

QUALITY RADIO CENTER

U/10, NAVRANG TOWER, SATADHAR CROSS ROAD, SOLA ROAD,
AHMEDABAD - 380061, GUJARAT, INDIA

is in compliance with the requirements of the following standard

ISO 9001:2015

SCOPE OF CERTIFICATION

"Manufacturer and Supplier of ROYAL WORLD CLASS FOUNTAINS,
Musical Dancing Fountains, Laser Show, Light & Sound Show,
RGB LED Lights Water Proof, Fountain NOZZLES, Fountain
Accessories, FRP Sculpture & Programmable Fountains"

Certificate Number : 170619019101

Certificate Initial Date : 17 Jun 2019
1st Surveillance Date : 17 May 2020
2nd Surveillance Date : 17 May 2021
Certificate Expiry Date : 16 Jun 2022

To verify certificate, visit at :

ARS Website : www.arscert.com/search-client/
UAF Website : www.uafaccreditation.org/search-details/
IAF Website : www.iafcertsearch.org

Accreditation No. : 51901390123



Issued by ARS Assessment Private Limited

Abhishek
Managing Director

UAF IS A FULL MEMBER OF INTERNATIONAL ACCREDITATION FORUM (IAF).

UAF Address : 3510, Colimar, Norfolk, VA 23509, United States of America :

CAB Address : 2/29 Vinamra Khand, Gomti Nagar, Lucknow-10, India

This certificate remains the property of ARS and must be returned to ARS on Cancellation or Suspension of the certificate. Validity of the certificate is subject to successful completion of surveillance audits. Further clarification regarding the scope of this certificate and the applicability of standard may be obtained by consulting the Organisation on info@arscert.com

India, Singapore, Indonesia, UAE, Saudi Arabia, Qatar, Japan, Jordan, Malaysia, Oman, Taiwan, Vietnam, Egypt, Turkey, Iran

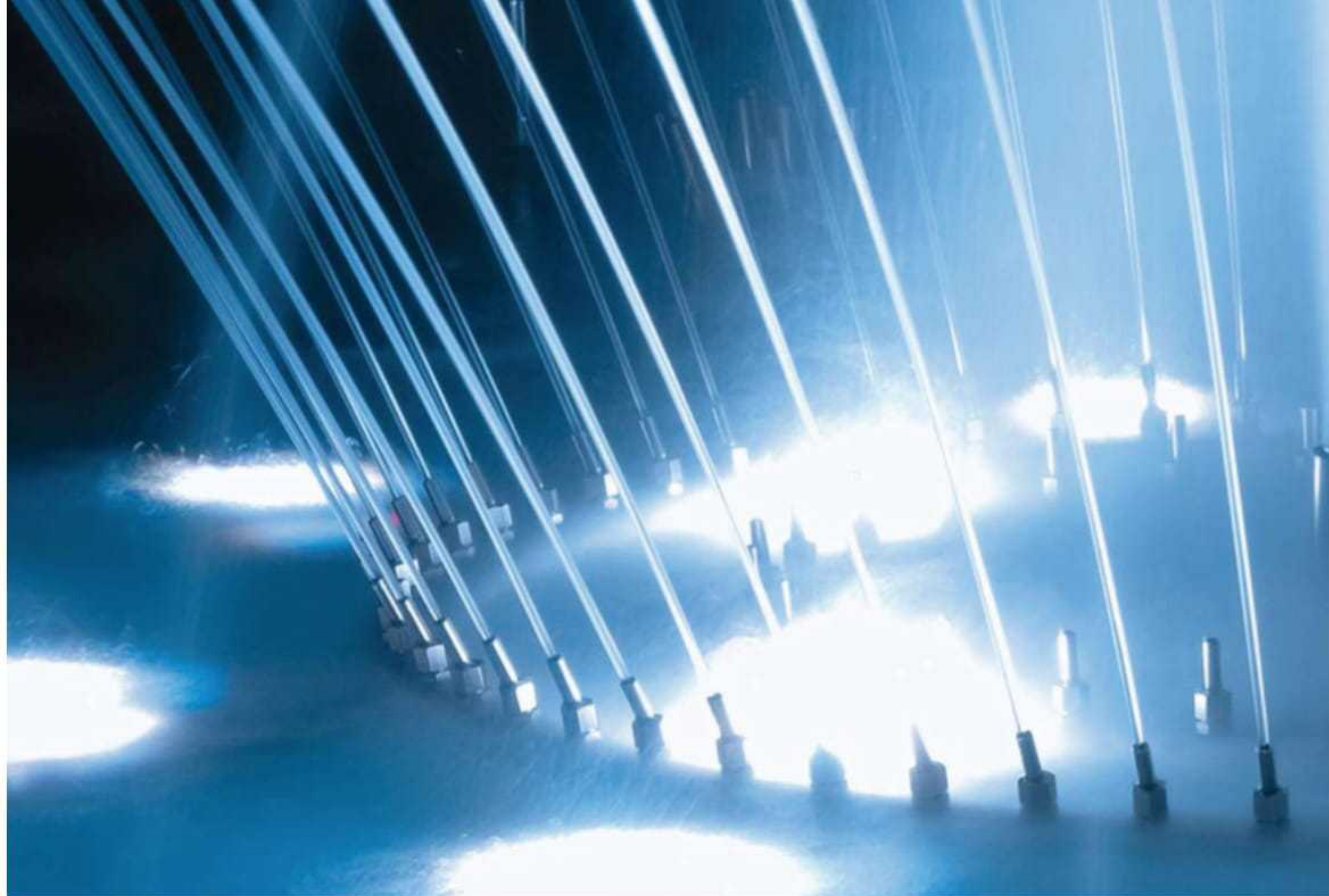

Angle Adjustable Clear Stream Jets

Angle Adjustable clear stream jets are most adaptable and cost efficient nozzle to produce crystal-clear water effect on illuminating. An array of adjustable clear stream jets arranged in lines or rings formation create delighted water effects. The nozzle is adjusted up to 15o off center to the axis for ease of installation and designing various water patterns. A flow straightener is nestled internally for nozzles of 3/8"-1 1/2" inlets. This in turn helps in better alignment of water molecules optimum use of pump head. Better alignment of water results in lesser friction resulting in great spray height from less pressure.

Material of Construction : Brass, Nickle Plated

Visibility 

Wind Resistance 

Sound Level 

Splash 

Aeration Quality 



Nozzle Technical Specifications

Model No	Inlet BSP/NPT	Nozzle's Orifice	Dimensions A x B	Spray Height	Spray Height In Meter										
					1	1.5	2	2.5	3	3.5	4	5	6	7	9
RWCFC8	1/8"	3	52 x 17		2.1 1.30	2.5 2.00	3.1 2.5	3.2 3.00	4.1 4.00	4.5 4.50	5.1 5.00	-			
RWCFC9	1/4"	4	46 x 14		2.2 1.30	2.8 2.00	3.2 2.5	3.4 3.00	4.4 4.00	5.1 4.50	5.5 5.00	-			
RWCFC10	3/8"	5	70 x 22		5.8 1.30	6.8 2.00	7.8 2.5	8.5 3.00	9.7 4.00	11.1 4.50	11.5 5.00	12.6 6.20			
RWCFC11	1/2"	8	83 x 27		12.5 1.30	15.2 2.00	16.8 2.5	20 3.00	22 4.00		26 5.00	28.1 6.20			
RWCFC12	3/4"	12	110 x 36		22.4 1.30	29 2.00	32 2.5	36 3.00	40 4.00		48 5.00	53 6.20	61 7.5		
RWCFC13	1"	14	116 x 42		44.5 1.30	56 2.00	66 2.5	73.5 3.00	83 4.00		95 5.00	104 6.20	117 7.5	126.5 8.6	143.5 11

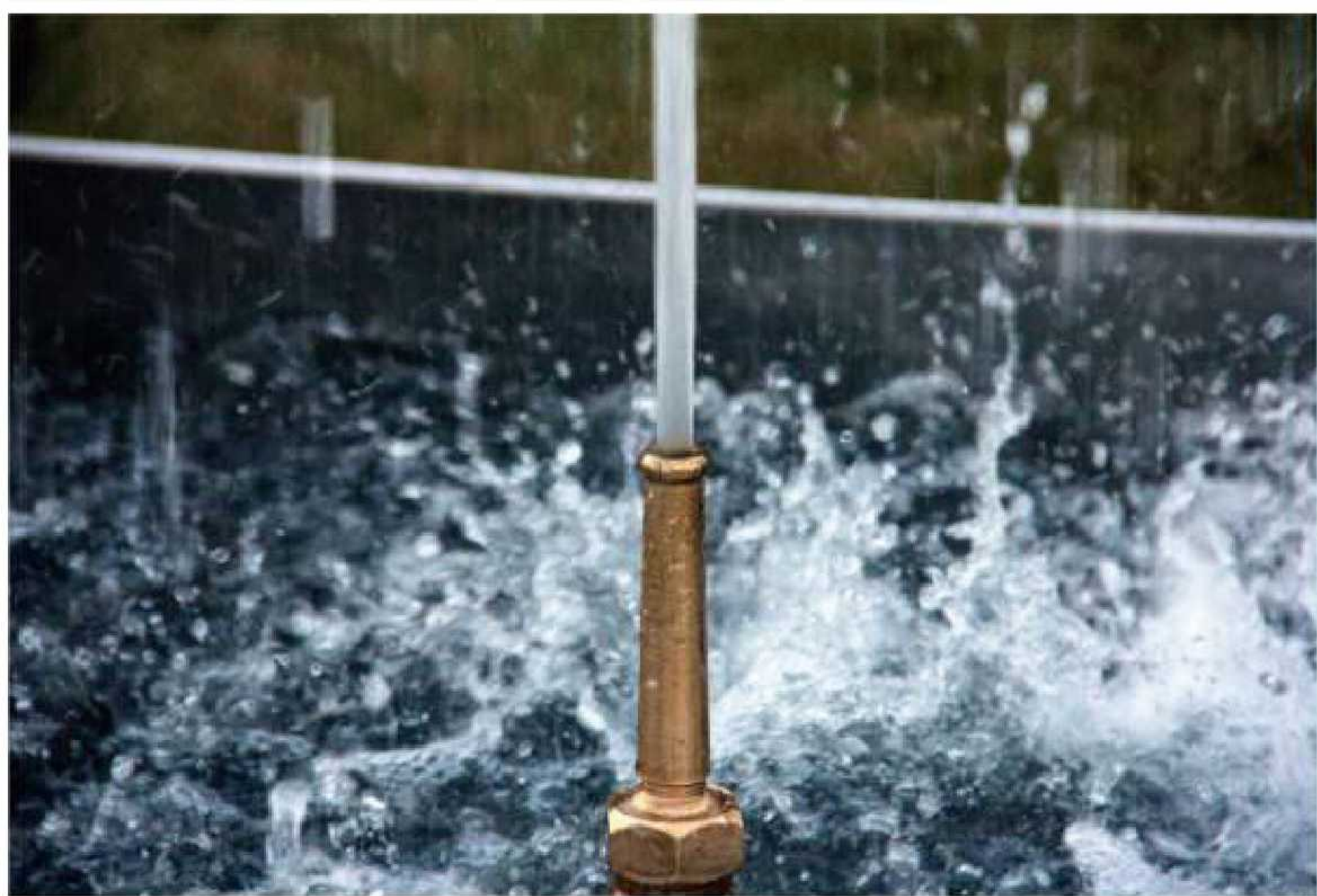

High Jet Nozzle

High jet nozzle is the preferred special nozzle when trying to achieve greater fountain height. It produces water in a clear streamed fashion comprising of high view ability. It is preferred in floating and lake fountains for choreographing water sequences. The nozzle can be illuminated by any choice of lighting in turn enhancing its effect.

An Internal flow Straightener is supplied with the nozzles. This in turn helps in better alignment of water molecules optimum use of pump head, better alignment of water results in lesser friction, resulting in great spray height from less pressure.

Material of Construction : Bronze

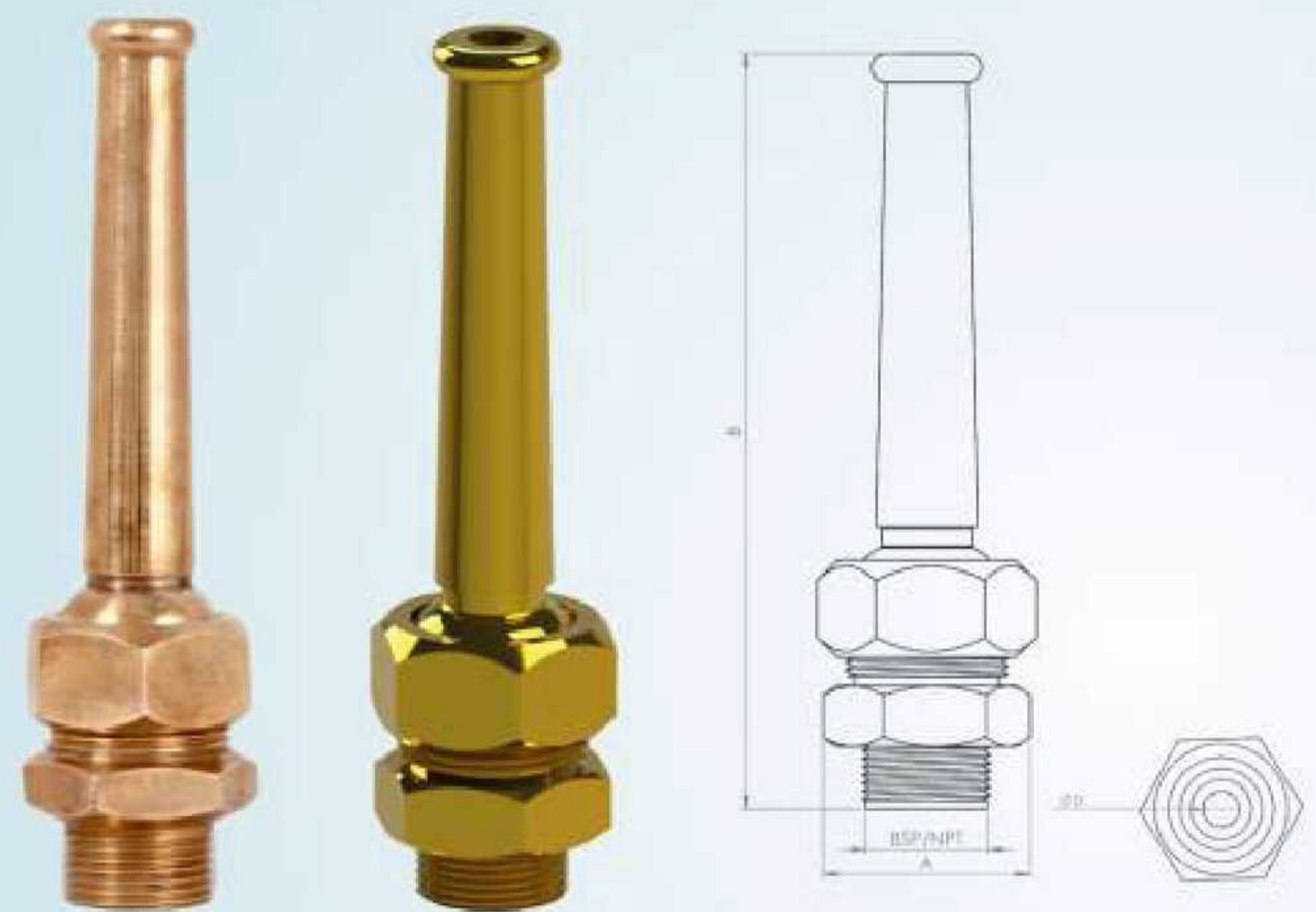

Nozzle Technical Specifications

Model No	Inlet BSP/NPT	Nozzle's Orifice	Dimensions A x B	Spray Height	Spray Height in Meter									
					1	1.5	2	3	4	5	6	7	8	9
RWCFH14	1"	14	54X195	LPM	40 1.20	51 1.82	60 2.40	80 3.70	95 5.00	100 6.00	112 7.30	122 8.50	140 10	140 11
RWCFH19	1.5"	19	65X200	Head (m)	-	-	125 2.50	160 3.75	186 4.90	208 6.20	225 7.50	245 8.00	265 9.80	

1.5" Nozzle can reach height up to 11 meters

Model No	Inlet BSP/NPT	Nozzle's Orifice	Dimensions A x B	Spray Height	Spray Height in Meter					
					10	15	20	30	40	50
RWCFH22	2"	22	100X230	LPM	340 13	400 20	450 26	-	-	-
RWCFH28	3"	28	155X340	Head (m)	540 15	700 22	780 30	1090 46	1310 60	-
RWCFH45	4"	45	222X445		1040 12	1300 18	1560 27	2070 40	2330 55	2670 70

Visibility Wind Resistance Sound Level

Splash Aeration Quality

Splash Aeration Quality



Foam Jet Nozzle

The Foam Jets are multipurpose, high performing, long lasting and yet cost effective as nozzles available in market today. The jet performs irrespective of water supply levels. Even in non linear water supply the Foam jet produces a solid and foamy water column. These Foam jets perform their full foam water column effect in just fraction of seconds making them perfect for choreographies and sequencing effects. Due to their versatile and cost effective behavior they are extremely popular among buyers today.



Material of Construction : Bronze

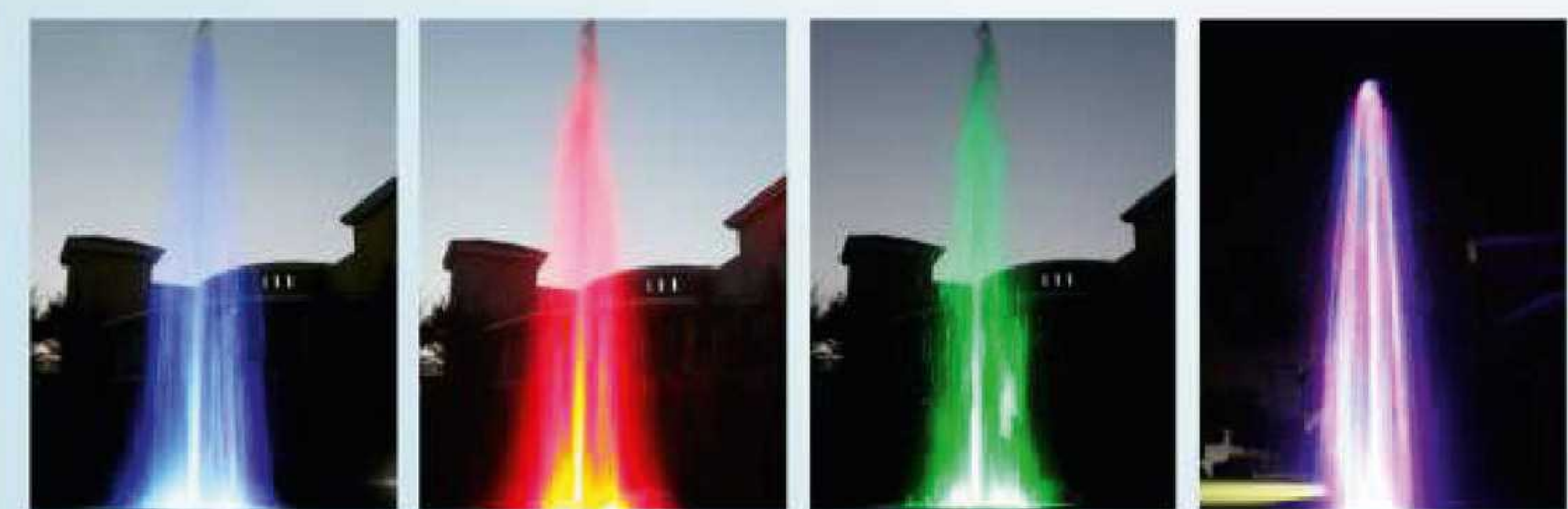

Nozzle Technical Specifications

Model No	Inlet BSP/NPT	Nozzle's Orifice D (mm)	Dimensions A x B	Spray Height In Meter	Spray Height In Meter						
					1	1.5	2	2.5	3	4	5
RWCFF100	1"	21	143X39	LPM1 Head (m)	35 2.00	41 2.60	49 3.5	54 4.5	59 5.00	70 7.00	-
RWCFF125	1.25"	coming soon							coming soon		
RWCFF150	1.5"	32	156X54		66 2.00	66 3.00	76.5 4.00	85 5.00	94 6.00	110 8.00	115 9.00
RWCFF200	2"	coming soon							coming soon		

Visibility Wind Resistance Sound Level

Splash Aeration Quality

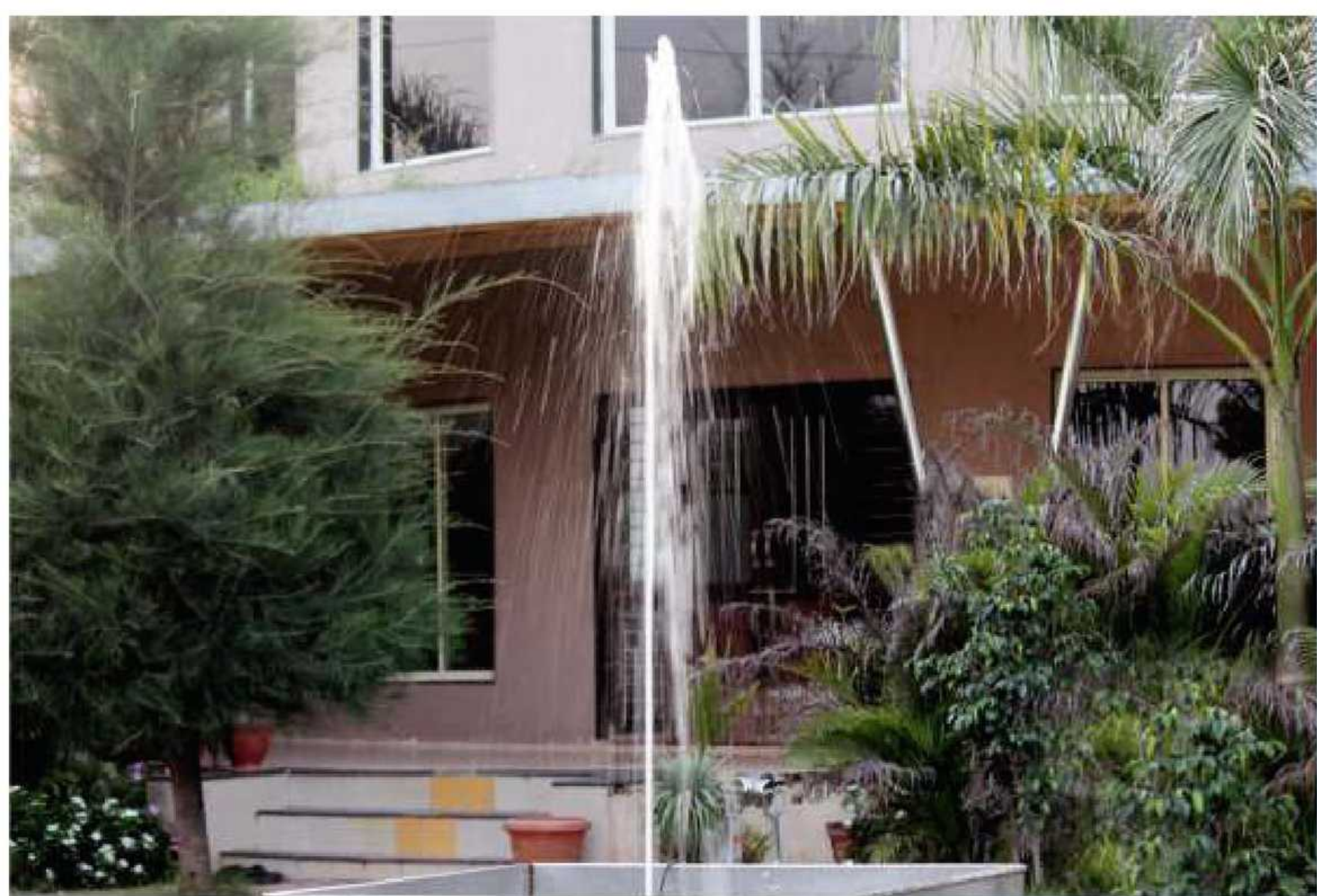

Deck Jet Nozzle

The Deck jet nozzles are ideal for indoor/outdoor pools and public water play areas. It requires a flush level deck mounting usually found in pools. The nozzle emits clear stream of water whose direction can be adjusted.

Material of Construction : Bronze

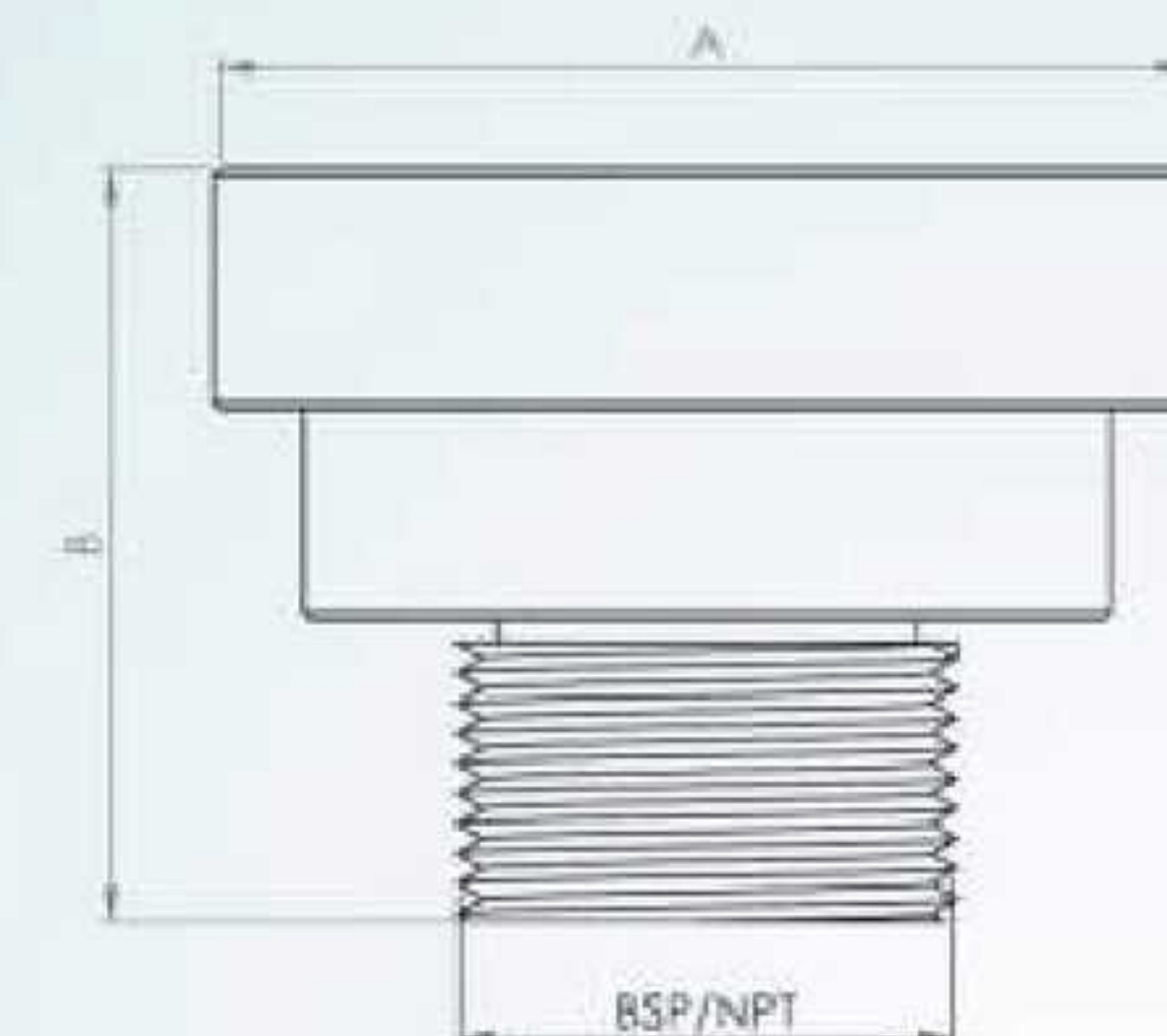

Nozzle Technical Specifications

Model No	Inlet BSP/NPT	Nozzle's Orifice	Dimensions A x B	Spray Height In Meter	Spray Height In Meter					
					1	1.5	2	2.5	3	4
RWCFD01	1"	12	65X55	LPM Head (m)	27 1.20	35 2.00	42 3.00	42 3.00	46 3.5	52 4.5

Visibility Wind Resistance Sound Level

Splash Aeration Quality





Tulip Nozzle

The Tulip nozzle is one of the most popular nozzles. They create an umbrella or mushroom form of clear water which acts as an oxygenator for natural water bodies (such as small lakes and artificial ponds). The heavy duty nozzle ensures stable, lasting and uninterrupted flow of water. It produces little or no splash making it ideal for windy places and can either be used in less airy locations. It looks ideal on floating or within a lake location. The thin film of water makes this nozzle one of the most popular in its series.

Material of Construction : Bronze



Visibility  Wind Resistance  Sound Level 

Splash  Aeration Quality 



Nozzle Technical Specifications

Inlet BSP/NPT	Dimensions A x B	Spray Height In Meter	Flow Head LPM Mtr
1	46 x 130	0.50	48 0.70
		1.00	75 1.40
1.5	64 x 146	0.25	48 0.5
		0.50	61 0.6
		0.75	74 0.6
		1.00	89 0.8
2	100 x 164	1.00	200 1.5
		2.00	300 3.00
		3.00	400 4.5
2.5	104 x 165	1.00	200 1.5
		2.00	300 3.00
		3.00	400 4.5





Water Bell Nozzle

Bell Nozzle as the name suggests create a water effects similar to a bell. The water falls in pattern which is sprouted round from the top and goes down in a bell shape pattern. It provides minimum sound and splash making it ideal for internal (or external wind free) locations in small or medium size capacity. Bell nozzle is best utilized when placed in grouped various heights. It does not require any constant level of water.

Material of Construction : Bronze

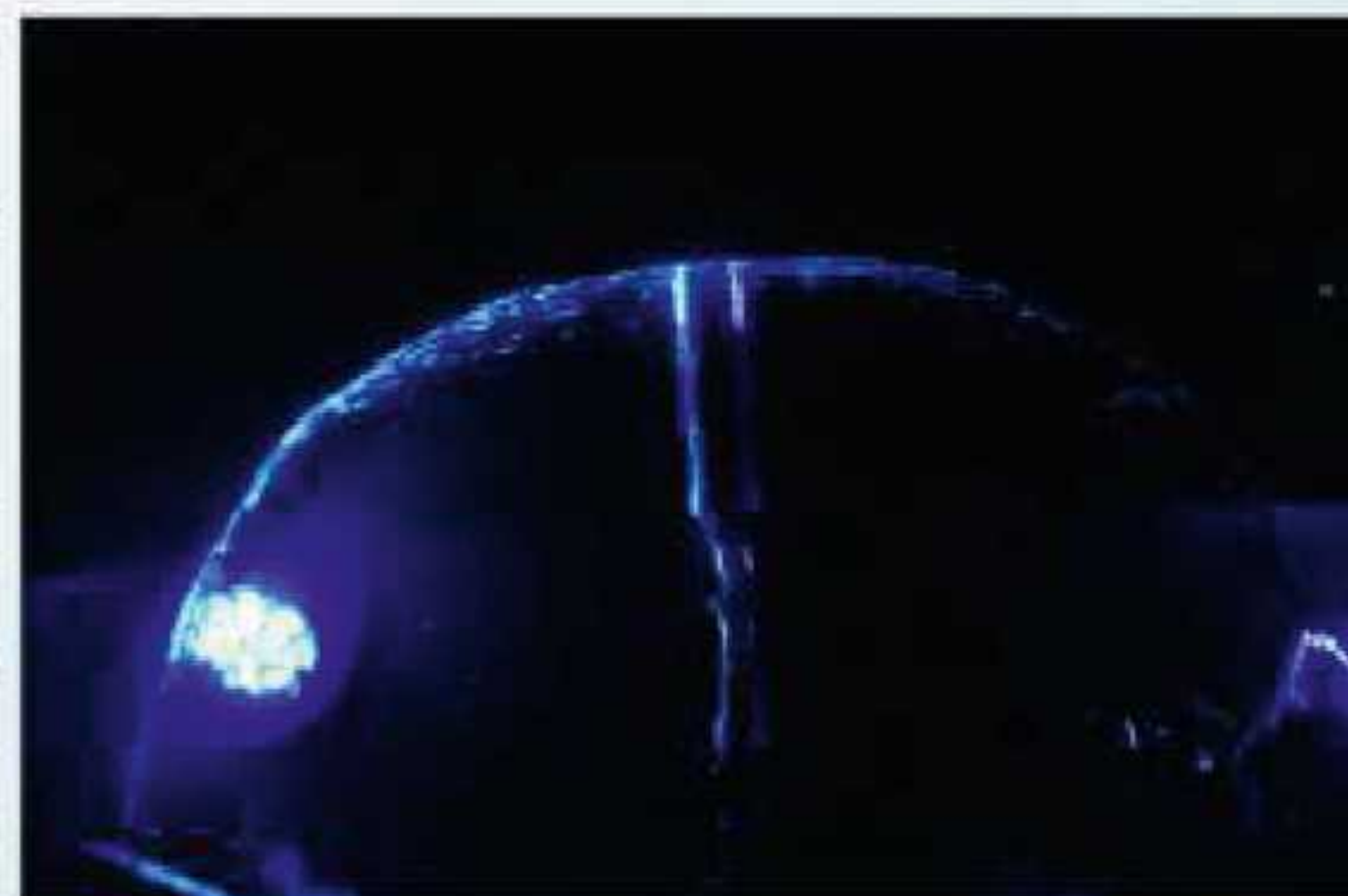

Visibility Wind Resistance Sound Level

Splash Aeration Quality

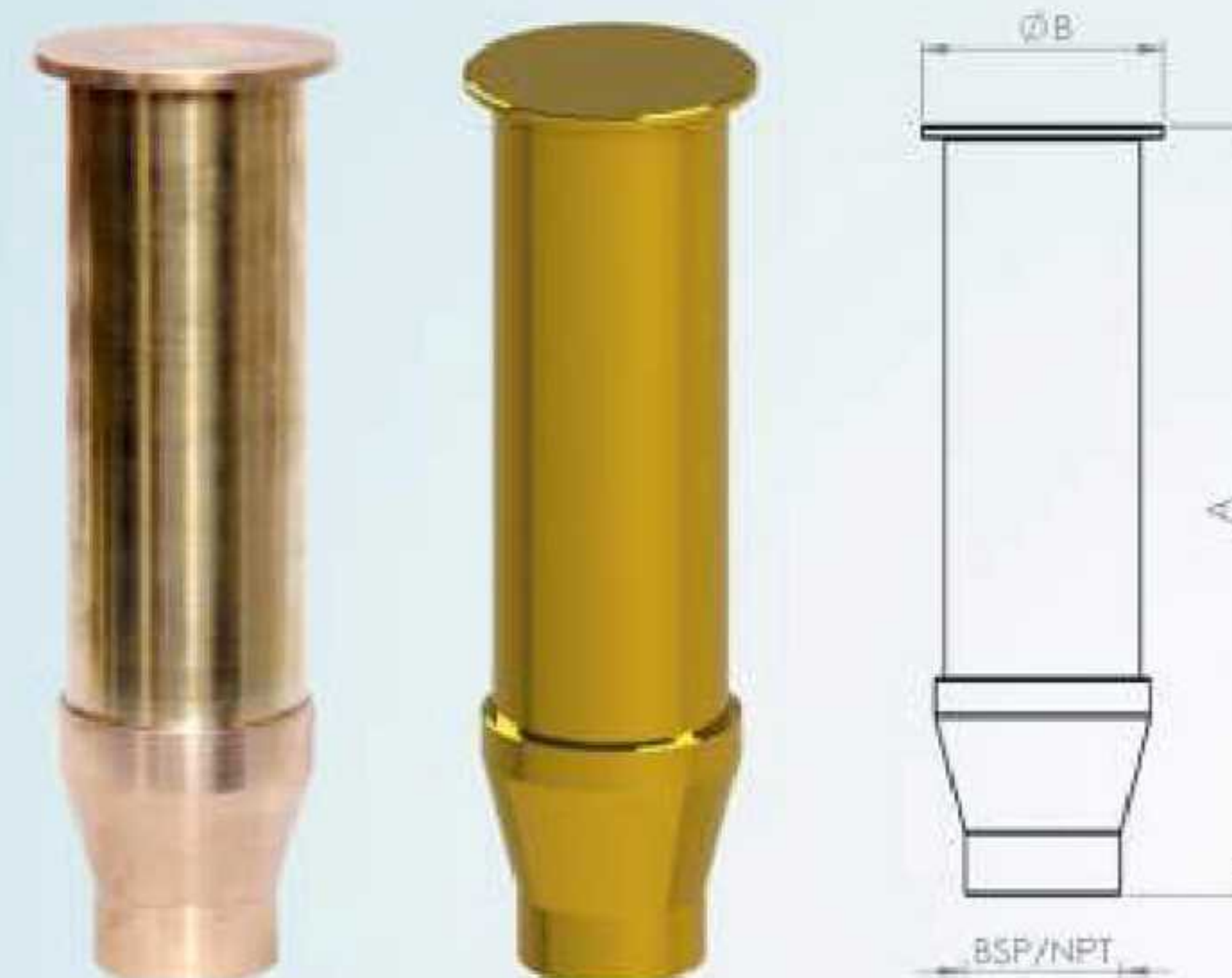

Nozzle Technical Specifications

Model No	Inlet BSP/NPT	Dimensions A x B	Bell Diameter mm	Flow (LPM)	Head (Meter)
RWCFB01	1/2"	31X108	Flow data measurement under process coming soon		
RWCFB02	1/2"				
RWCFB03	1/2"	62X163	150-300	15-40	0.70 - 1.50
RWCFB04	1"	62X163	150-300	15-40	0.70 - 1.50
			450-600	25-30	1.20 - 1.50



Cascade Nozzle

Cascade nozzle is a Gunmetal built fountain nozzle which emits conical shaped water patterns. The frothy effect created by this jet is achieved due to precise mechanism. The mechanism includes drawing water and air in correct proportions to be mixed and shot upwards in frothy elegant fashion. The height can be customized in accordance to the water level provided. They can be used in individually or grouped together in patterns formations. They work well in indoors and light wind areas.

Material of Construction : Bronze



Nozzle Technical Specifications

Model No	Inlet BSP/NPT	Nozzle's Orifice	Dimensions A x B	Spray Height In Meter	0.5	1	1.5	2	3	4	5	6
RWCFC01	1/2"	40	52 x 116	LPM Head (m)	30 2.00	44 3.00	-	-	-	-	-	-
RWCFC02	1"	50	63 x 158		80 2.00	98 3.00	122 5	135 7.00	156 8.00	-	-	-
RWCFC02.1	1"	65	75 x 150		80 2.00	98 3.00	122 5	135 7.00	156 8.00	-	-	-
RWCFC02.2	1"	50	72 x 158		80 2.00	98 3.00	122 5	135 7.00	156 8.00	-	-	-
RWCFC03	1.5"	70	85 x 220		89 2.00	102	146 5	165 7.00	211 8.00	242 12	281 15.1	-
RWCFC04	2"	100	115 x 270			200 3.00	290 4.50	315 6.50	378 8.00	420 12	470 15	500 18
RWCFC05	3"											

Coming Soon

Visibility Wind Resistance Sound Level

Splash Aeration Quality



Bubbler Nozzle

Bubbler nozzle creates an effect similar to white mounds of solid foam water in a scattered formation. The nozzle needs to be placed underwater and spray height is dependent upon the depth of its placement. The Foam geyser nozzle works by mixing air (snorkeled in) with water within it and then redirecting the pressurized mixture upwards. The final effect results in visible fluffy 'Bubble' white spray.

Material of Construction : Bronze



Nozzle Technical Specifications

Model No		Inlet BSP/NPT	Nozzle's Orifice	Dimensions (mm)			Spray Height In Meter	1	1.5	2	2.5	3	4	5
				F	B	A								
RWCFB100	Single Snorkel Pipe	1"	28	86	195	-		35 2.00	41 2.60	49 3.5	54 4.5	59 5.00	70 7.00	-
RWCFB101	Double Snorkel Pipe	1"	28	86	195	200		-	-	-	-	-	-	-
RWCFB125		1.25"	coming soon				LPM	-	-	-	-	-	-	-
RWCFB150	Single Snorkel Pipe	1.5"	32	115	210	-	Head (m)	54 2.00	66 3.00	76.5 4.00	85 5.00	94 6.00	110 8.00	115.5 9.00
RWCFB151	Double Snorkel Pipe	1.5"	32	115	210	200								
RWCFB200			coming soon											

Visibility Wind Resistance Sound Level

Splash Aeration Quality



Aerating Jet Nozzle

Aerating jets produce columns of water with frothy effect. The nozzle which creates rigid and efficient foam effects have long been admired across the globe. The light fountain comes alive due to high light reflection of scream quality of the nozzle jets. The uniqueness of inner nozzle consisting of internal tapered bore utilizes optimum use of water transforming it into foam The sturdy cast Gunmetal and brass stock, machined to close tolerance made these nozzles ultimate consumer dream. Water Level Dependent Nozzle.

Material of Construction : Bronze & Brass Pipe



Nozzle Technical Specifications

Model No	Inlet BSP/NPT	Nozzle's Orifice (D)	Dimensions A x B in mm	Spray Height In Meter	1	2	3	4	5	6	8
RWCFA01	1"	22	32 x 155	LPM I Head (m)	20 5.00	31 8.00	39 13.00	48 19.00	59 24.00	63 30.00	-
RWCFA02	1.5"	30	55 x 190			38.5 5.5	62 10.5	62 13.00	76 18.00	80 20.00	103 30.00
RWCFA03	2"	40	115 x 340		42.5 4	55 7	75 10	90 14	105 18		
RWCFA04	3"	-	-					Coming Soon			

Visibility 🌊🌊🌊🌊🌊 Wind Resistance 🌊🌊🌊🌊🌊 Sound Level 🌊🌊🌊🌊🌊

Splash 🌊🌊🌊🌊🌊 Aeration Quality 🌊🌊🌊🌊🌊

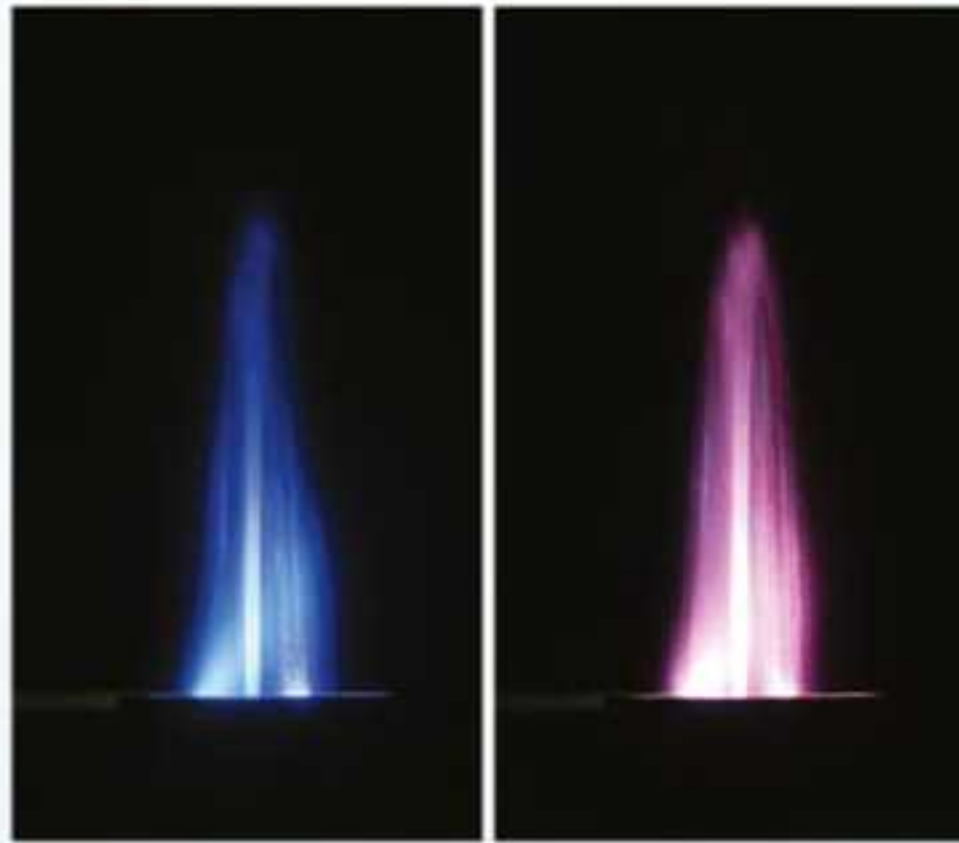
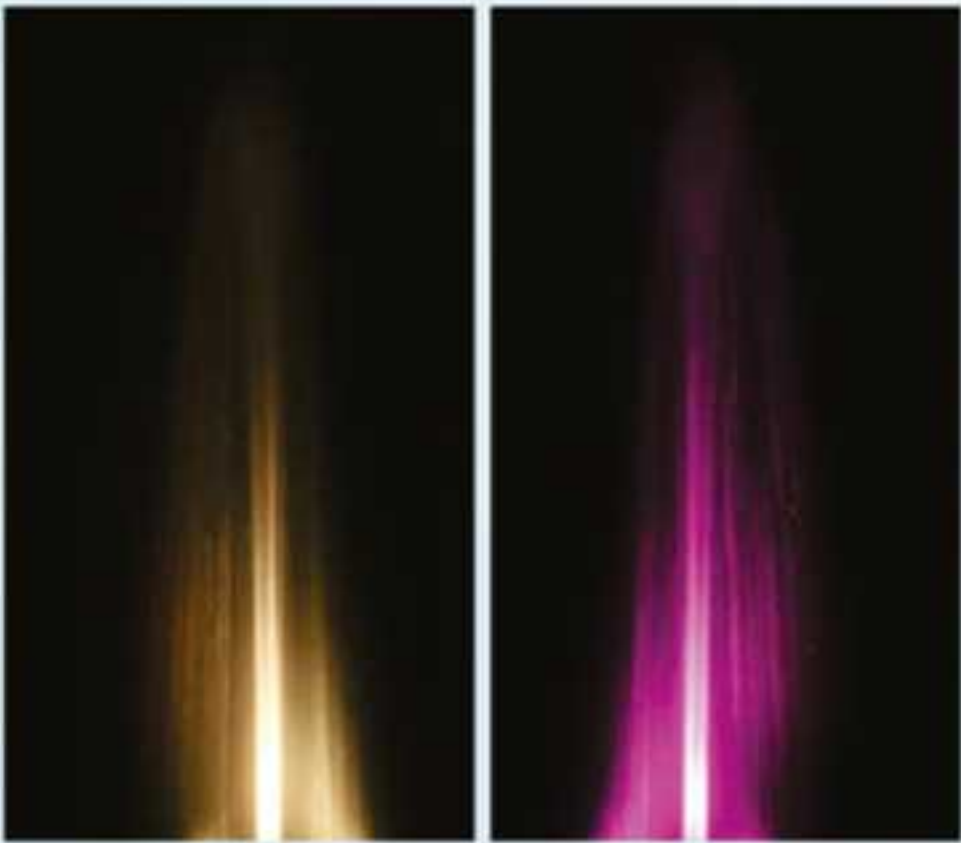
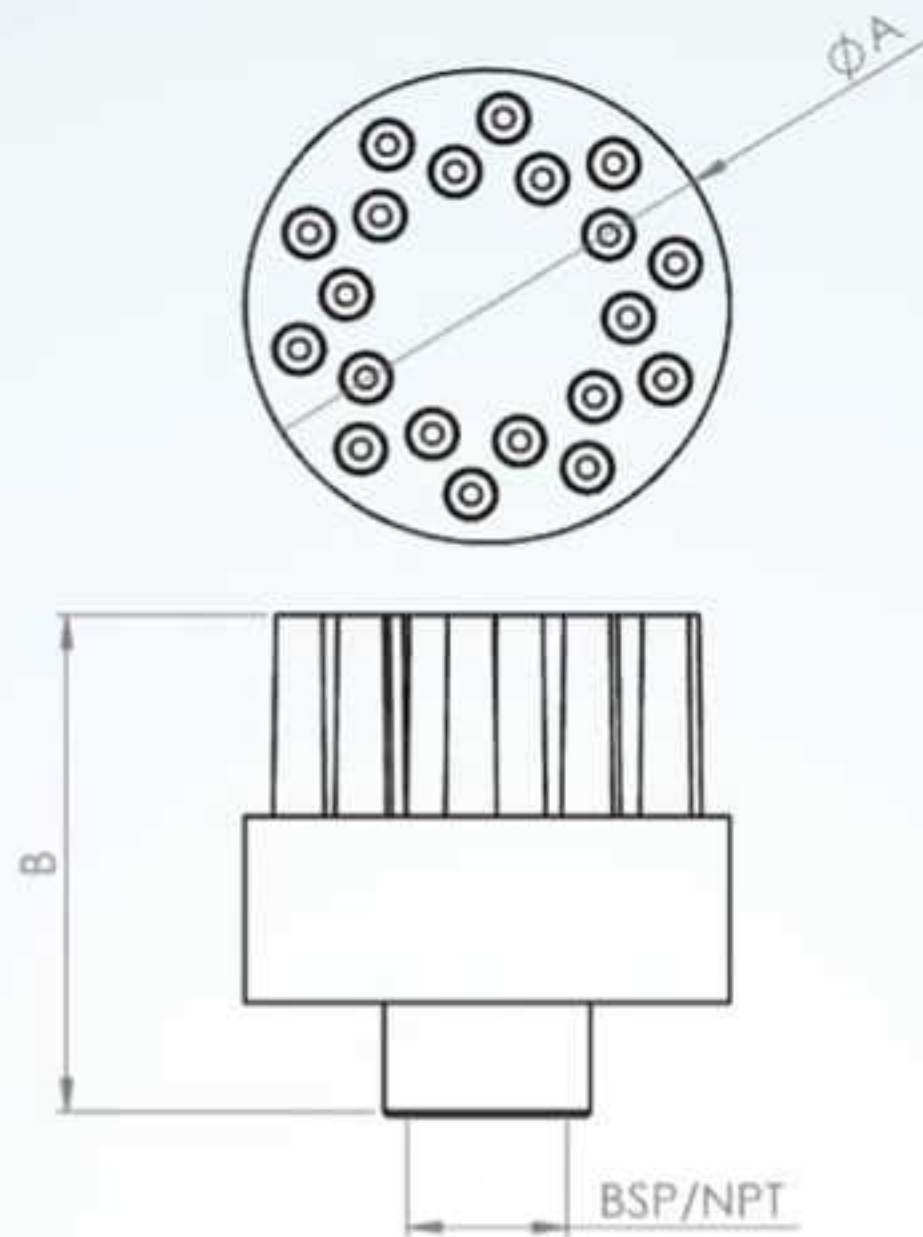

Cluster Jet Nozzle

Cluster Jet nozzles produces erect water columns by combining nozzles in a biding fashion. The round head consists of smaller nozzles arranged in circular fashion to produce water streams shooting upwards and combining to appear in a perpendicular fashion. The combination enables them to shoot water at great heights making them highly visible. They can be used as a single or used in combination of multiple instances.



Material of Construction : Bronze

Visibility Wind Resistance Sound Level
Splash Aeration Quality

Nozzle Technical Specifications

Model No	Inlet BSP/NPT	No of Nozzles	Nozzle's Orifice	Dimensions A x B	Spray Height	Spray Height In Meter									
						0.5	1	1.5	2	2.5	3	3.5	4.5	6	
RWCFC01	1"	12	3mm	78 x 68	LPM I Head (m)	18.50 0.70	25.00 1.60	31.00 2.30	35.50 3.00	39.00 3.60	44.00 4.40				
RWCFC02	1"	20	3mm	95 X 100	LPM I Head (m)										
RWCFC03	1.5"	24	4mm	200 X 130	LPM I Head (m)	40 0.70	55 1.50	66 2.30	73 3.00	82 3.60	92 4.40				
RWCFC04	2"	42	4mm	200 X 130	LPM I Head (m)	102 1	165 2	115 2.75	262 3.5	300 4	348 5				385 5.5
RWCFC06	4"	48	5mm	254 X 160	LPM I Head (m)						1100 6.11		1370 10	1600 12.5	



Finger Jet Nozzle

Finger jets as the name suggests are nozzles with finely shaped finger tips protruding from the base. They create arc spray patterns that can be used to enhance large water creations or use as standalone in indoor or shielded outdoor environment. The clear precise jets create exquisite spray patterns in throwing arc pattern. They produce minimum splash or noise and a delight to watch from all angles. They can be customized to be 6 or 12 nozzles in single or multiline patterns. They complement water sprays when done in series or create patterns form various arrangements.

Material of Construction : Bronze



Nozzle Technical Specifications

Inlet BSP/NPT	No of Nozzle	Nozzle Type	Dimensions A x B in mm	Spray Length	Spray Height In Meter				
					1	2	3	4	5
-			Spread at fall=>		1.5m	2.5m	3.3m	4.2m	5m
1"	9	Adjustable	40 x 130	LPM Head (m)	25 1.00	33 1.50	45 2.50	50 3.00	55 4.00
1.5"	11	Adjustable	64 x 140		20 1.20	100 2.00	156 8.00	135 3.50	

Visibility 🌊🌊🌊🌊🌊 Wind Resistance 🌊🌊🌊🌊🌊 Sound Level 🌊🌊🌊🌊🌊

Splash 🌊🌊🌊🌊🌊 Aeration Quality 🌊🌊🌊🌊🌊



Fan Jet Nozzle

Fan Jet creates a particularly compact, fan shaped water stream with a thickness of 6 mm. The Fan jets are a delight to watch and captivates one's attention when arranged in attractive group patterns. Its effect shines most when angled between 35-90 degrees off horizon. Fan jets are convenient to use as they are water level independent requiring only non-turbulent, linear water supply. For effect optimization place LEDs close to the nozzle of jets pointing them towards middle of stream. They are made from solid 304 stainless steel material.

Material of Construction : Bronze

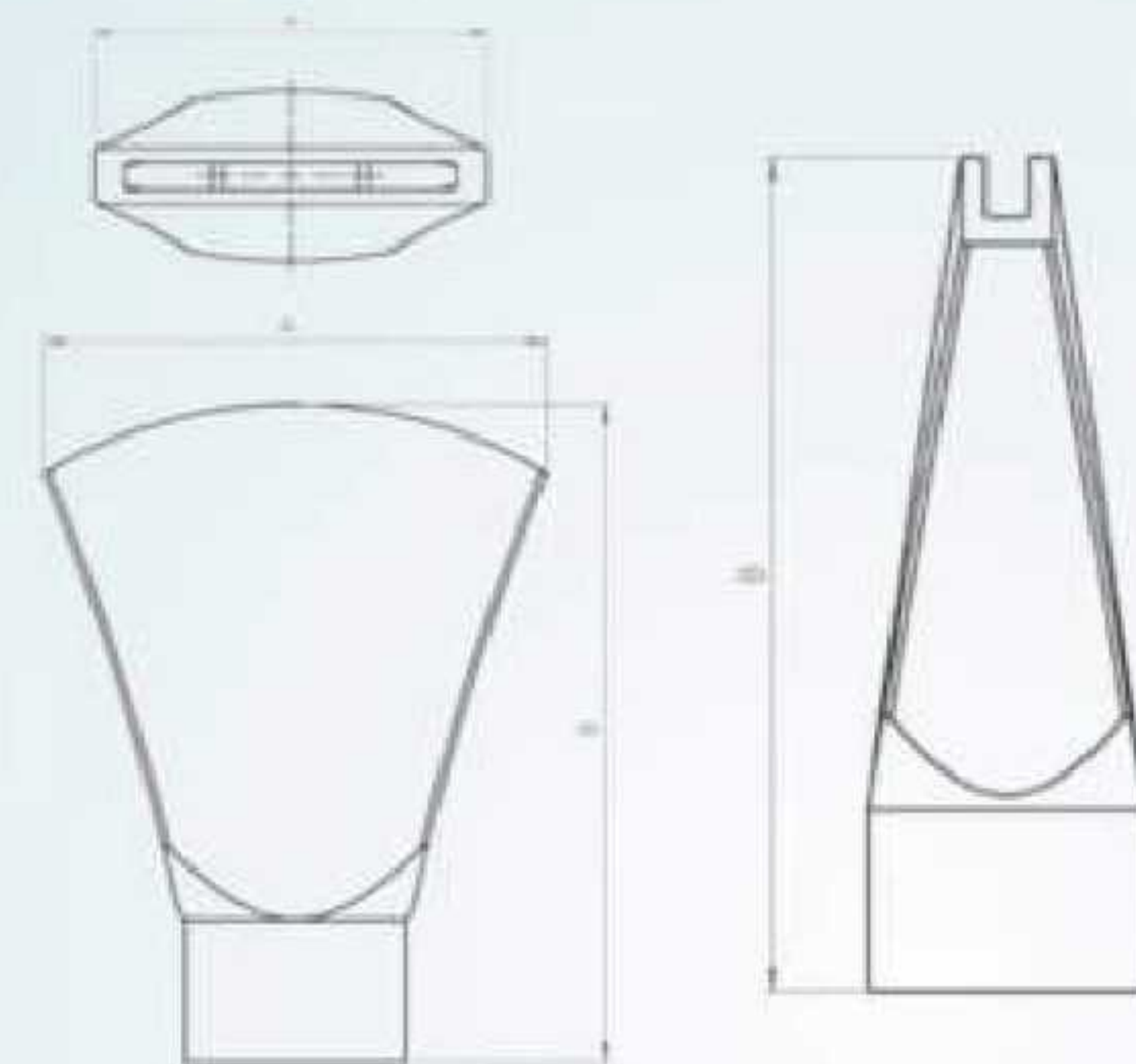

Visibility  Wind Resistance  Sound Level 

Splash  Aeration Quality 

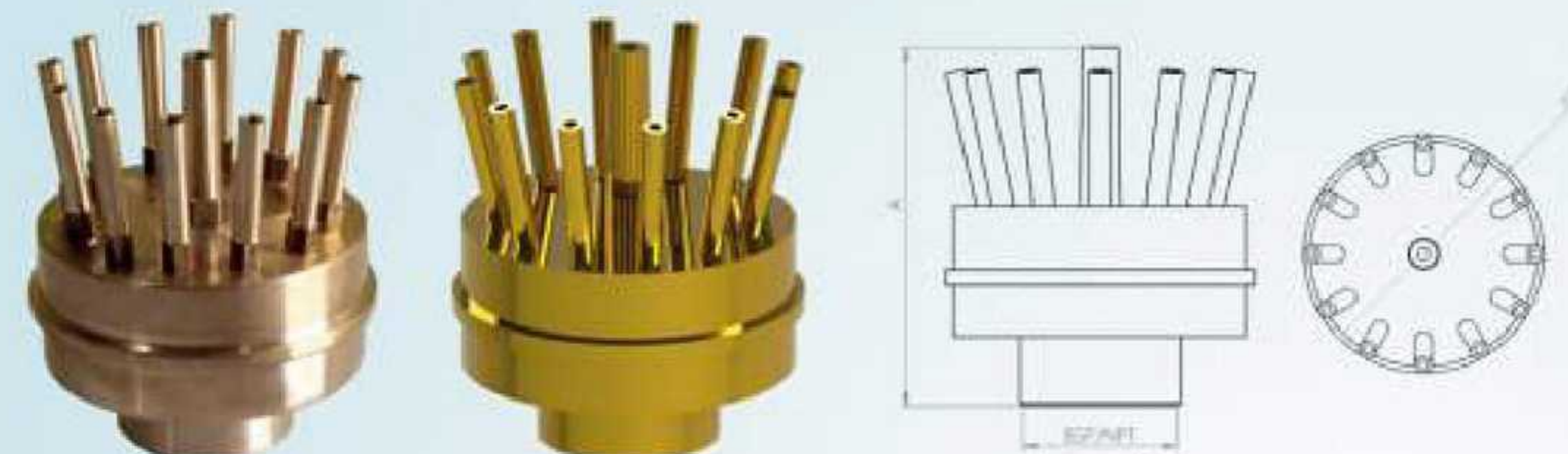

This nozzle helps create an elegant two tiered pattern resembling an armorial bearing in a sleeker manner. The construction of these nozzles has been inspired by the natural sword lily flower. The head consists of Gunmetal graded material with jet holes for an enhanced state of beauty. The larger model is made of Gunmetal graded material with nozzles which are prefixed with Fixed brass JETS or adjustable Brass nozzles to customize the design of water flow by adjusting nozzle angle. These are also independent of water level.



Visibility Wind Resistance Sound Level

Splash Aeration Quality

Nozzle Technical Specifications

Model No	Inlet BSP/NPT	No of Jets	Orifice of Jets	Dimensions A x B in mm	Spray Height In Meter	Fixed Jets					
						1.5	2	2.5	3	4	5
RWCFF201	1"	7	4.00/3.00	91 x 74	LPM l Head (m)	Flow data measurements under process					
RWCFF202	1"	13	4.00/3.00	91 x 74							
RWCFF203	1"	19	6.00/4.00	100 x 95							
RWCFF204	1.5"	25	8.00/6.00	-							
RWCFF205	2"	25	8.00/6.00	-							

Model No	Inlet BSP/NPT	No of Jets	Orifice of Jets	Dimensions A x B in mm	Spray Height In Meter	Adjustable Jets					
						1.5	2	2.5	3	4	5
RWCF201	1"	7	4.00/3.00	91 x 74	LPM Head (m)	Flow data measurements under process					
RWCF202	1"	13	6.00/4.00	100 x 95							
RWCF203	1.5"	25	6.00/4.00	-							
RWCF204	2"	25	6.00/4.00	-							



Lily Nozzle

Lily nozzle as the name suggests creates flower shaped patterns of clear water. They can be seen from far and suitable for outdoor and indoor. They can be used individually or in combination of other fountains to give enhanced water effects.

Large and small models are available for this design. Both are made from superior quality Gunmetal for an extensive life and smooth running. Both nozzles do not require minimum level of water.

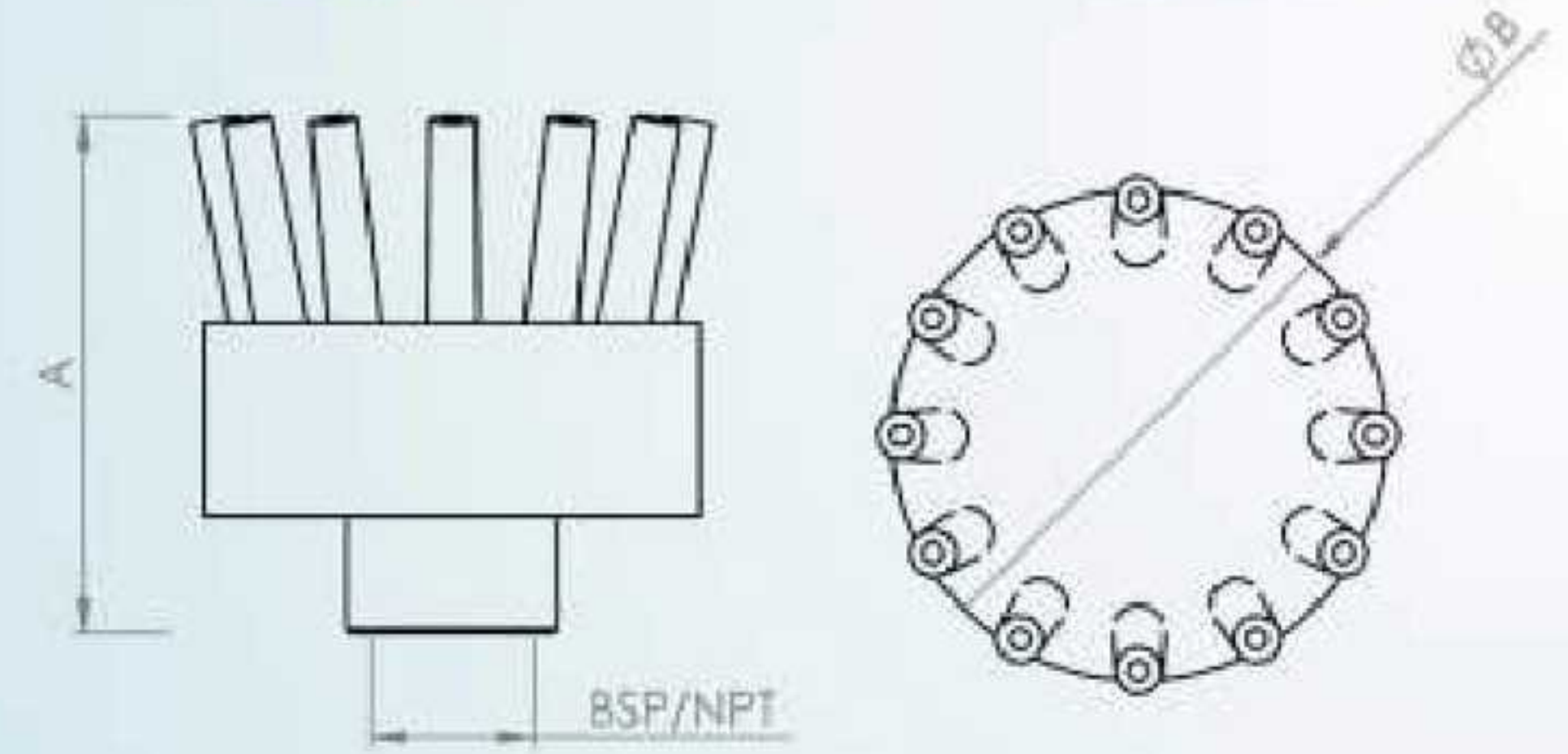

Material of Construction : Bronze

Nozzle Technical Specifications

Model No	Inlet BSP/NPT	No of Jets	Nozzles Orifice A (mm)	Dimensions A x B in mm	Spray Height In Meter	0.5	1	1.5	2	2.5	3.5	4
RWCFL01	1"	12		87 x 75		20 1.00	25 1.5	28 2	36 3	40 3.5	45 5	-
RWCFL02	1"	12		105 x 95		21 1.00	25.5 1.5	28.5 2	37 3	41 3.5	46 5	-
RWCFL03	1.5"	18		-	LPM I Head (m)	Flow data measurements under process						
RWCFL04	2"	24		-		Flow data measurements under process						
RWCFL05	3"					Coming Soon						

Visibility Wind Resistance Sound Level
 Splash Aeration Quality



Rotating Nozzle

The Rotating nozzle is most popular in its class for creating beautiful, intricate pattern of water. The rotating nozzle is a part of dancing fountain class. The beauty and simplicity of nozzle lies in no mechanical structuring, the water simply flows from precisely angles six nozzles along with another nozzle in middle. They are used in outdoors to add beauty to massive structures.

Material of Construction : Bronze



Revolving Nozzle Technical Specifications

Inlet BSP/NPT	Dimensions A x B in mm	Spray Length	Spray Height In Meter					
			1	1.25	1.50	1.80	2	1.80
1"		LPM	20 1.00	25 2.00	28 3.00	35 4.00	36 5.00	40 6.00
1.25"		Head (m)	20 1.00	25 2.00	28 3.00	35 4.00	36 5.00	40 6.00

Peacock Tail Nozzle Technical Specifications

Inlet BSP/NPT	Dimensions A x B in mm	Spray Length	Spray Height In Meter					
			2.5	3	3.50	4.00		
1.25"		LPM	122 3	130 4	152 5	163 6	-	-
		Head (m)	122 3	130 4	152 5	163 6	-	-

Visibility  Wind Resistance  Sound Level 

Splash  Aeration Quality 



Dandelion Nozzle

A finesse and artful water effect is created by the Dandelion nozzles. The Dandelion Sphere or hemisphere effect of water is achieved by multiple discs of water radiating from a center manifold. The effect produces a fine spray resulting in evaporation cooling in the area creating a tranquil environment. It achieves unsurpassable beauty with combined with various illuminations. Even unused the structure resembles a sculpture ideal for mall and garden area.

Material of Construction : Bronze



Visibility  Wind Resistance  Sound Level 

Splash  Aeration Quality 

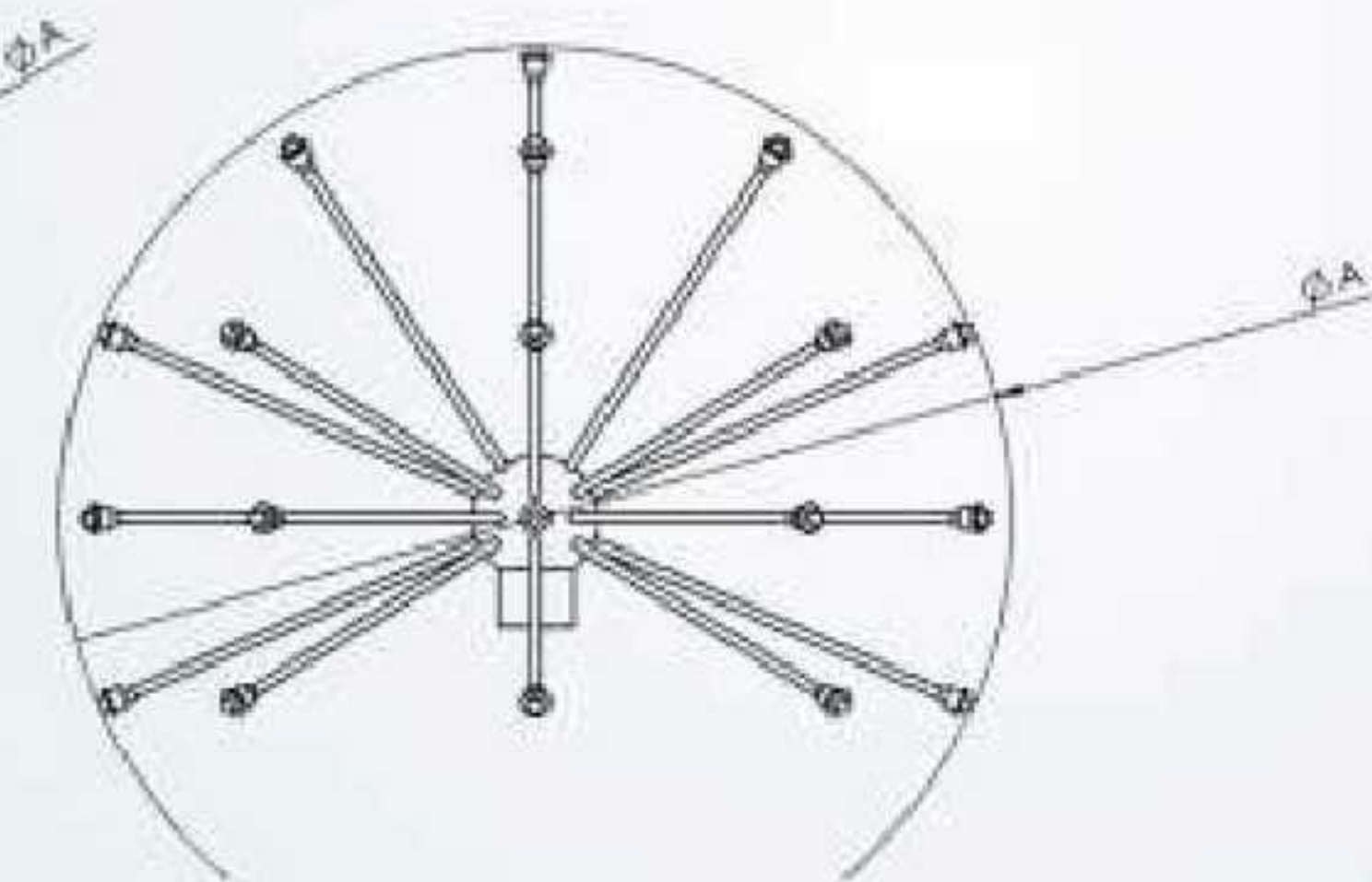
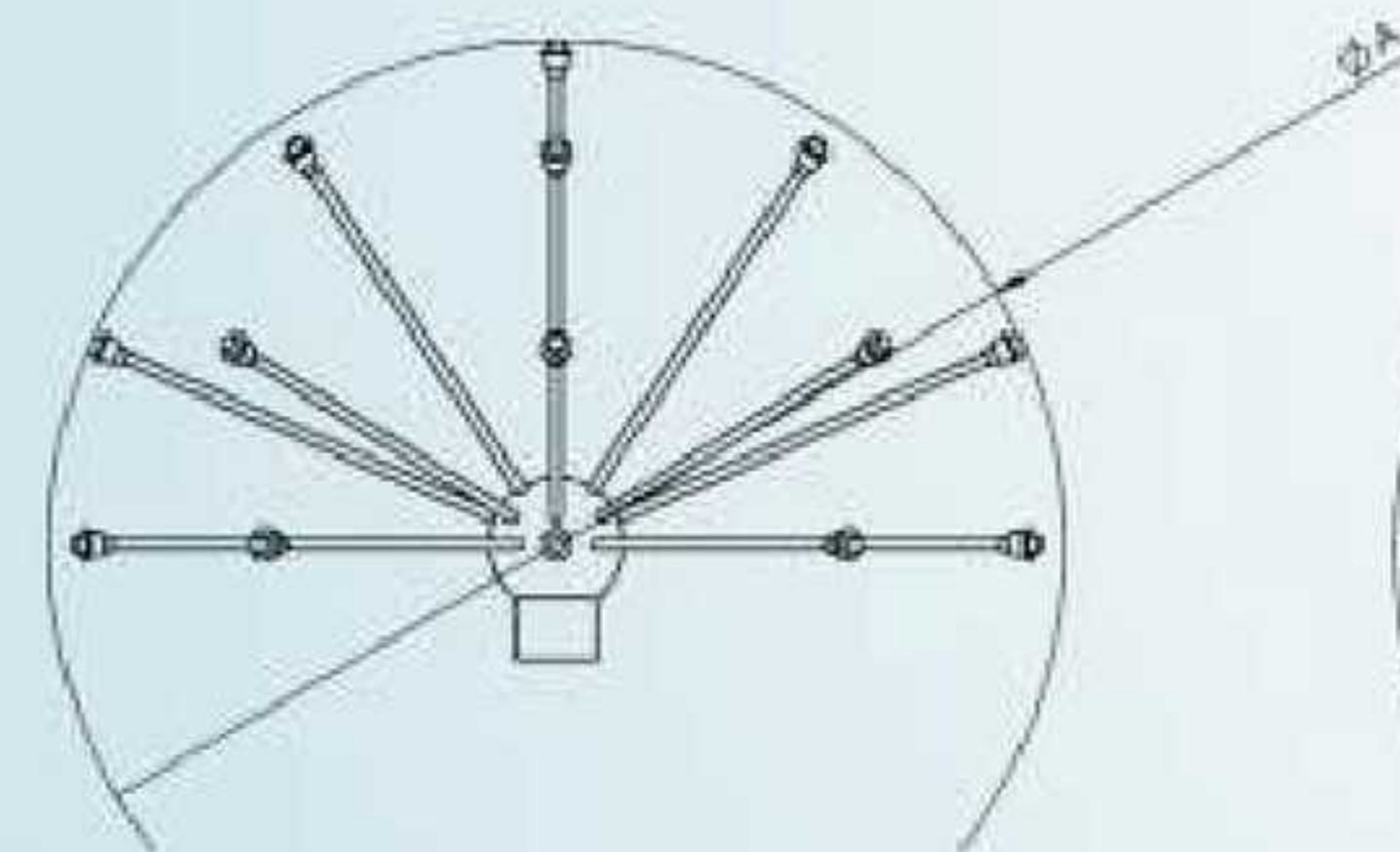
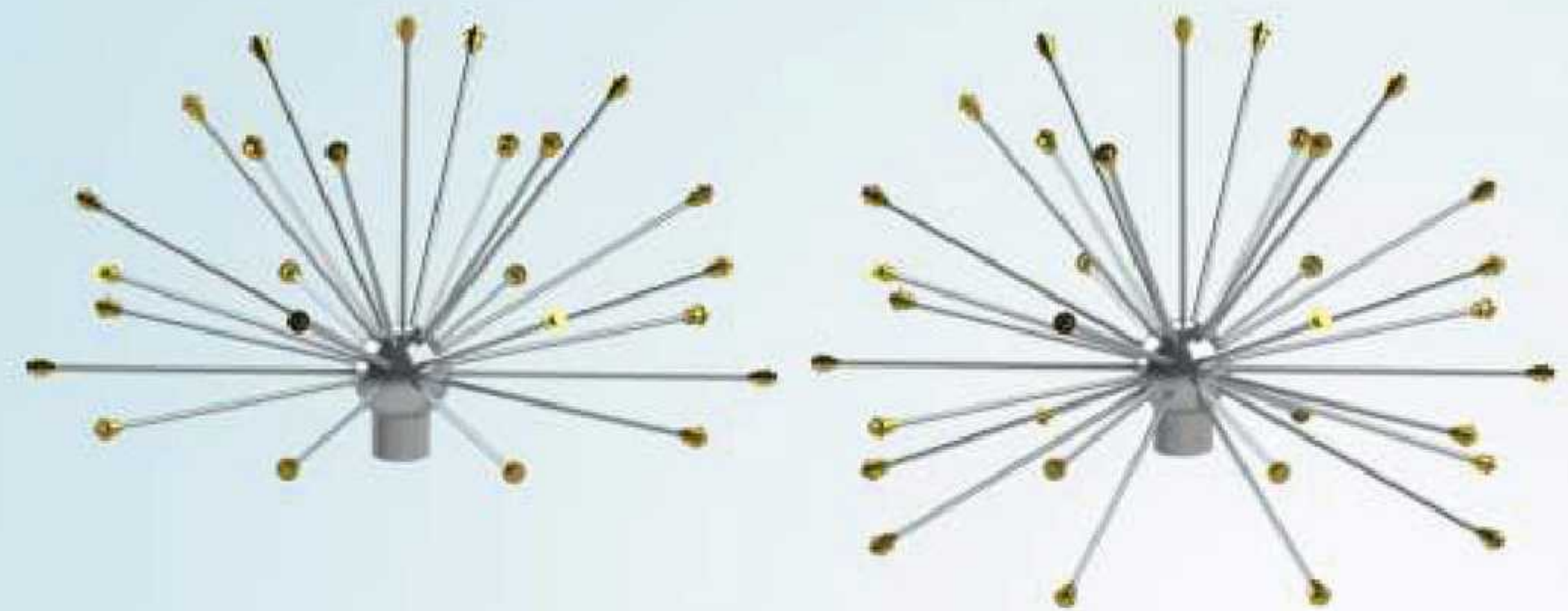

Full Sphere Nozzle Technical Specification

Inlet BSP/NPT	Nozzle/s Diameter	Number of Diameter	LPM	Head in Meter
2.5"	1 mtr	42	452	5
3"	1.5 mtr	62	615	9
3"	1.5 mtr	110	1502	7

Dandelion Hemisphere Nozzle Technical Specification

Inlet BSP/NPT	Nozzle/s Diameter	Number of Arms	LPM	Head in Meter
2.5"	1 mtr	41	450	5
3"	1.5 mtr	41	480	7